

Features & Benefits

- Large 25mm or 1" LCD Display
- High Accuracy
- Selectable Units te, lbs, kN & kg
- High Resolution
- Compact Size
- Tare
- Preset Tare
- Lightweight
- Overload Counter
- 90dB Audible Set Point Alarm
- RS-485 Serial Output
- Corrosion-Resistant Finish

Optional connection to Crosby Straightpoint's Handheld Plus
Model - **HHP (T24)**
Part No. **2789459**

This small and compact Crosby Straightpoint mini crane weigher scale will suit most lifting applications and is available in capacities from 100kg to 5t.

Worldwide, it is one of Straightpoint's most popular products and has been manufactured since 1987. The Miniweigher Plus crane scale offers robust construction, high accuracy, compact size and extreme portability.

Utilised by utility companies on every continent, the Miniweigher Plus crane scale is quite often mounted between a winch and a tripod. This mounting point allows for load monitoring to be integrated within the lift, ensuring safety levels during the lowering and raising of equipment and/or personnel are optimised. It has proven itself to be an indispensable tool for underground sewer, water, gas and utility vault access.

The Miniweigher Plus features full function push button controls for tare, choice of units (lbs, kg, kN and tonnes), peak hold, preset tare, audible set-point alarm and an overload counter.

Straightpoint's advanced microprocessor based electronics provide the Miniweigher Plus with high speed read rates, extreme resistance to industrial level noise and unprecedented stability. This high stability allows 5,000+ divisions and the highest standard resolution of any compact digital crane scale on the market today. The unit also features a RS-485 serial output providing added functionality and versatility.

In all, the lightweight design, corrosion-resistant finish, advanced electronics and full feature display have made the Miniweigher plus crane scale the only choice when looking for a compact, safe and accurate, crane scale.

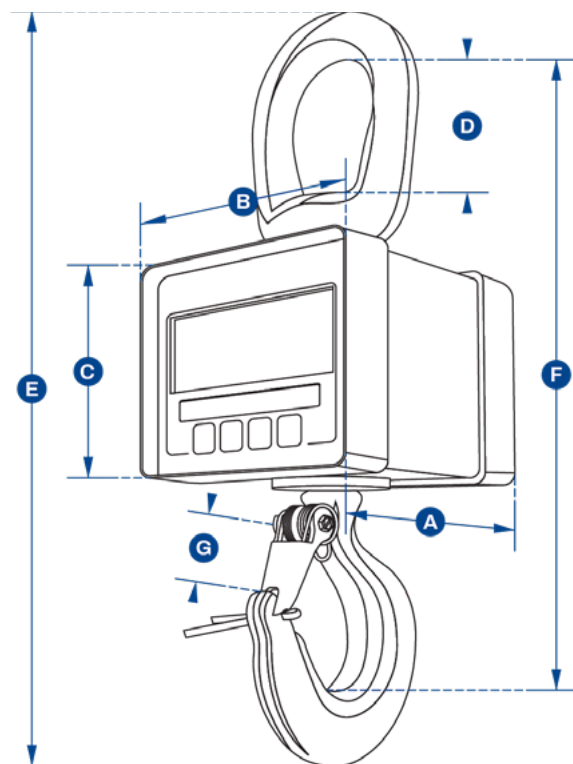

SP Model	MWP100KG	MWP250KG	MWP500KG	MWP1T	MWP2T	MWP5T
Crosby Part	2789055	2789057	2789059	2789056	2789058	2789060
Capacity	100 kg	250 kg	500 kg	1,000 kg	2 te	5 te
	220 lb	550 lb	1,100 lb	2,200 lb	4,400 lb	11,000 lb
Resolution	0.05 kg	0.1 kg	0.2 kg	0.5 kg	0.001 te	0.001 te
	0.1lb	0.2 lb	0.5 lb	1 lb	2 lb	2 lb
Units	t, kg, kN, lb					
Weight	1.5 kg	1.5 kg	1.5 kg	1.5 kg	3.1 kg	8.7 kg
	3.3 lb	3.3 lb	3.3 lb	3.3 lb	6.8 lb	19.2 lb
Safety Factor	10:1	5:1	5:1	5:1	5:1	5:1
Protection	IP65 / NEMA4x					
Battery Type	9v PP3					
Battery Life	80 hrs continuous					
Display Type	6 digit 25 mm LCD / 6 digit 1 in LCD					
Operating Temp	-10 to +50 °C / 14 to 122°F					
Accuracy	+/- 0.1% FS					
Dimension A	81	81	81	81	117	136
	3.19	3.19	3.19	3.19	4.61	5.35
Dimension B	112	112	112	112	112	112
	4.41	4.41	4.41	4.41	4.41	4.41
Dimension C	81	81	81	81	92	92
	3.19	3.19	3.19	3.19	3.62	3.62
Dimension D	33	33	33	33	43	62
	1.30	1.30	1.30	1.30	1.69	2.44
Dimension E	222	222	222	222	283	349
	8.74	8.74	8.74	8.74	11.14	13.74
Dimension F	183	183	183	183	238	286
	7.20	7.20	7.20	7.20	9.37	11.26
Dimension G	22	22	22	22	28	42
	0.87	0.87	0.87	0.87	1.10	1.65